

606/7 John Street Mascot NSW

1  1  1 

On offer, this immaculate extra large apartment offering a wide square floorplan boasting an extra spacious appeal flooded with natural light. Located just metres from all amenities in a low maintenance building, this unit presents the perfect entry level buy into the Mascot station Precinct.

Features:

- * Large main bedroom with built-in
- * Spacious Lounge and dining with adjoining study space
- * Immaculate stone bench kitchen with dishwasher
- * Modern full main bath
- * Ducted air-conditioning
- * Expansive balcony with open district views
- * Security parking
- * Total 94sqm * Apartment 81sqm

Price : Under Offer

View : <https://www.rre.com.au/7920641>



Michael Michos
0296672868

Just moments to Mascot Station, Woolworths, bus

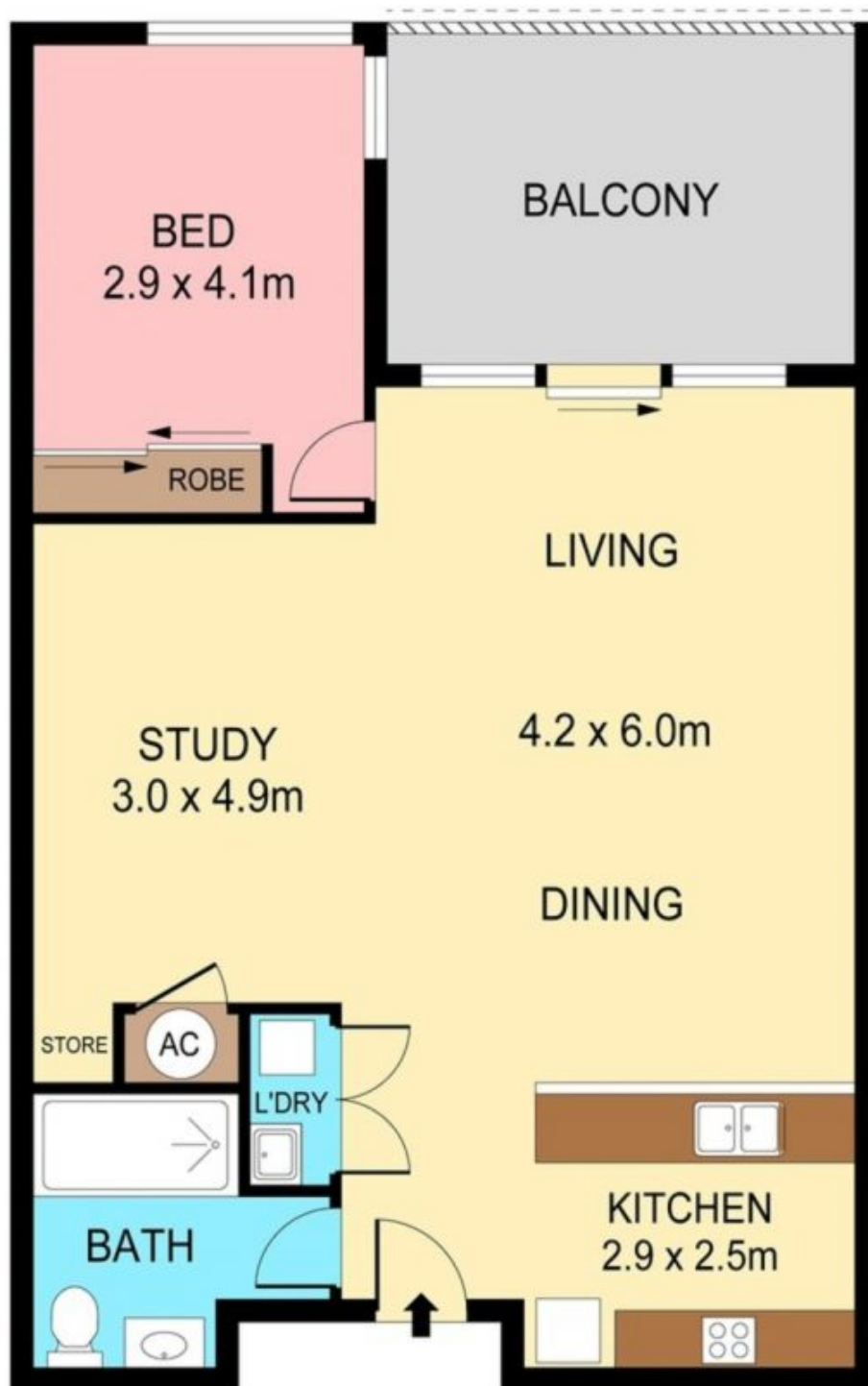

PLANS SHOWN ONLY INDICATIVE OF LAYOUT. DIMENSIONS ARE APPROXIMATE.
Ref. No. 66734

606/7-10 JOHN STREET



MASCOT