



135 Salisbury Road CAMPERDOWN NSW

3  3  1 

On offer, this stunning new tri-level contemporary residence that represents a new benchmark for inner city living. Be entranced by this special residence that is the last offering for this award winning Master-Built boutique development in Camperdown.

Uncompromising luxury throughout with natural stone, designer European fixtures plus all of today's cutting edge technologies. Ultra modern architecture that emphasis interior light, space and versatility whilst capturing the essence of low maintenance executive family living.

Features:

- *3 expansive bedrooms all with vogue stone ensuite bathrooms, built-ins and private balconies and courtyard
- *Lounge and dining with perfect dual flowing access to both front and rear entertainers courtyards
- *Full Stone designer 900mm gas kitchen with integrated

View : <https://www.rre.com.au/721456>



Michael Michos
0296672868



Ground Level

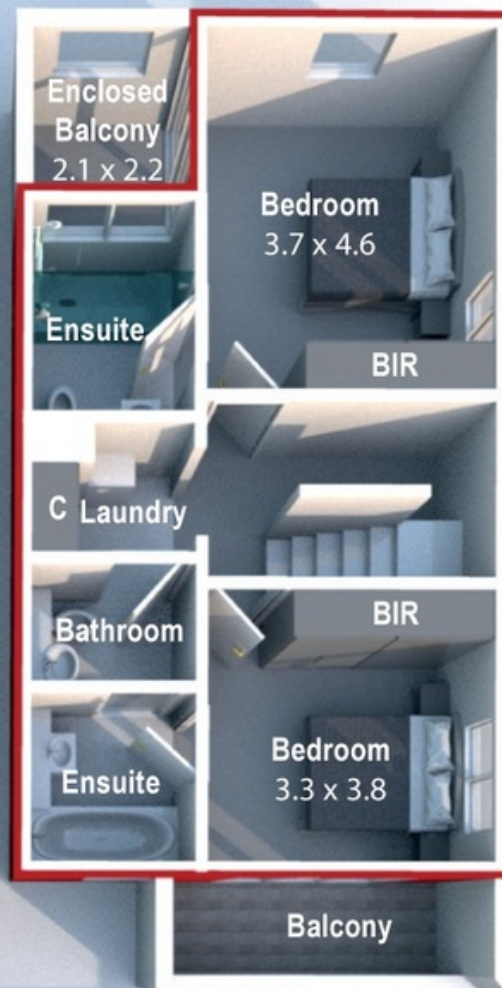

First Level



Second Level