

**2/22 Barber Avenue Eastlakes NSW**

1  1  1 

Private Appointments Available - Call 0412 877 086

RRE is proud to offer this rare, perfect entry level first home or investment situated on the first floor of one of Eastlakes finest security buildings. Located conveniently opposite the Eastlakes Shopping Center and main park, features include:

- \*Large main bedroom
- \*Spacious combined lounge and dining
- \*Tidy Kitchen and bathroom
- \*Separate downstairs lock-up laundry with tub on title
- \*Private rear side driveway leading to carspace on title.

This building is one of the best in Eastlakes having undergone an impressive transformation in recent years. Eastlakes is quickly becoming a recognised jewel in Sydney's South-East. Only 10 minutes to Sydney's CBD

**Price** : \$ 475,000

**View** : <https://www.rre.com.au/6501124>



**Michael Michos**  
0296672868



**LEVEL ONE**

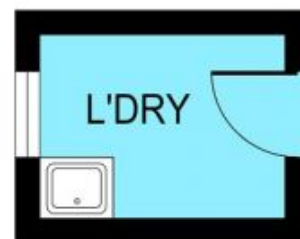

**GROUND LEVEL**



**2/22 Barber Avenue Eastlakes**

DISCLAIMER: ARTUM PLANS SHOWN ARE FOR PRESENTATION PURPOSES & ARE NOT PART OF ANY LEGAL DOCUMENT. ALL MEASUREMENTS & FIGURES ARE APPROXIMATE.