



531 Gardeners Road Rosebery NSW

2  1  1 

Looking to create your own vision in booming Rosebery? This charming original two storey terrace presents a blank canvass for your creativity with all the great fundamentals in place to capitalise on in this ultra convenient location. Featuring original appointments throughout, the possibilities are endless for this entry level home. This renovator's delight includes:

- *Two spacious bedrooms, main with enclosed balcony
- *Spacious lounge and dining areas with original fireplace and ornate ceilings
- *Original kitchen and bathroom
- *Spacious rear yard plus front courtyard
- *Rear Lane access for potential parking.

Properties such as these are becoming an absolute rarity in Rosebery. Located just metres to the Cannery's eateries, parks, Australian golfcourse, Rosebery shops, schools and bus transportation at your doorstep. Genuine vendor and

Price : \$ 1,150,000

View : <https://www.rre.com.au/6063693>



Michael Michos
0296672868

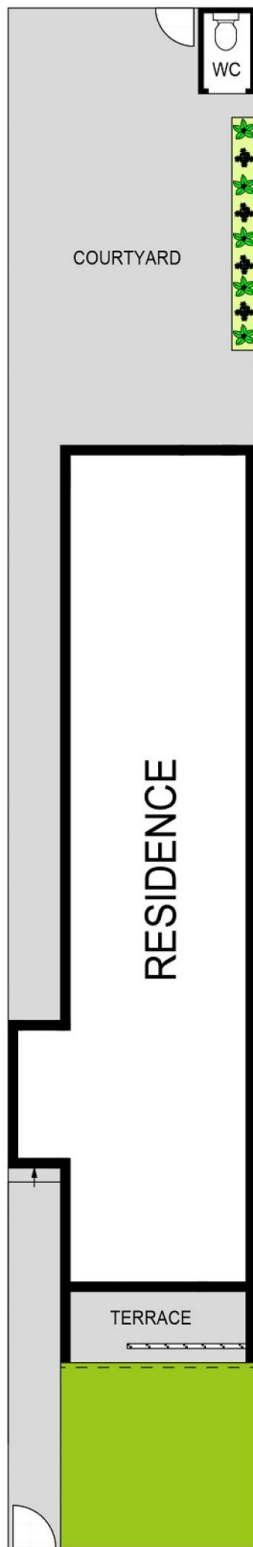

SITE PLAN
(NOT TO SCALE)

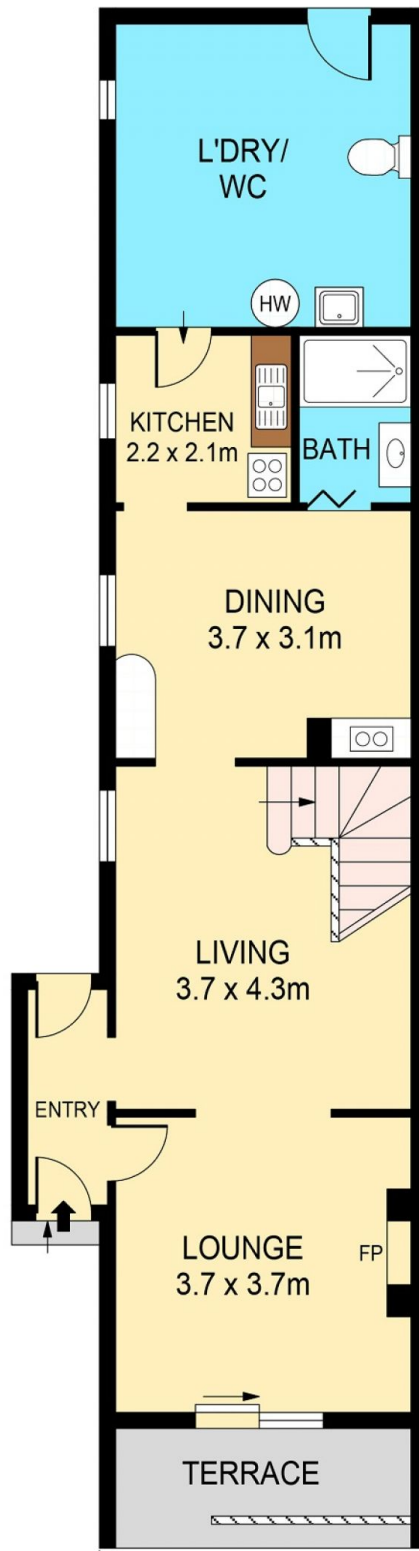

GROUND FLOOR

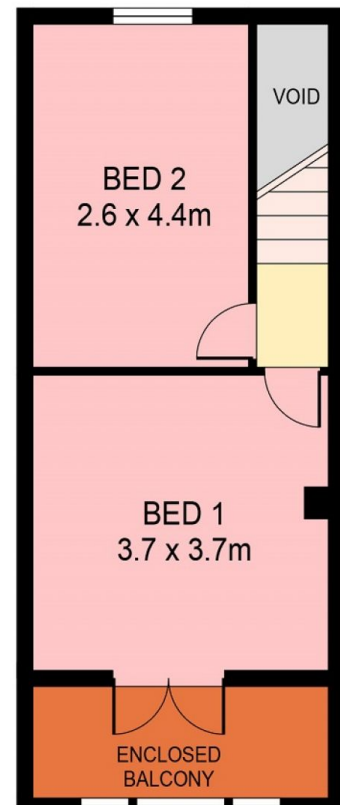

FIRST FLOOR



PLANS SHOWN ONLY INDICATIVE OF LAYOUT. DIMENSIONS ARE APPROXIMATE.
Ref. No: 85878



531 GARDENERS ROAD

ROSEBERY