



**10 Tramway Street ROSEBERY NSW**

3  1 

RRE Properties is proud to offer this fantastic family home located in the booming suburb of Rosebery. This full brick home has been updated and is sure to impress the growing family with both its space and low maintenance living. Features include:

- \*3 large Bedrooms with Built-ins
- \*Separate formal lounge and dining areas
- \*Extra large modern eat-in kitchen
- \*Immaculate main bathroom
- \*Rear large sunroom/4th bedroom
- \*External laundry facilities
- \*Easy maintenance backyard with undercover pergola.

This gem of a property is the perfect affordable home offering affordability and convenience with easy street parking. Location is first class with bus stop at your doorstep with easy access to CBD, Mascot and Green Square Train stations just moments away, Rosebery

**Land Size** : 240 sqm  
**View** : <https://www.rre.com.au/557873>



**Michael Michos**  
**0296672868**



**Jim Michos**  
**0296672868**

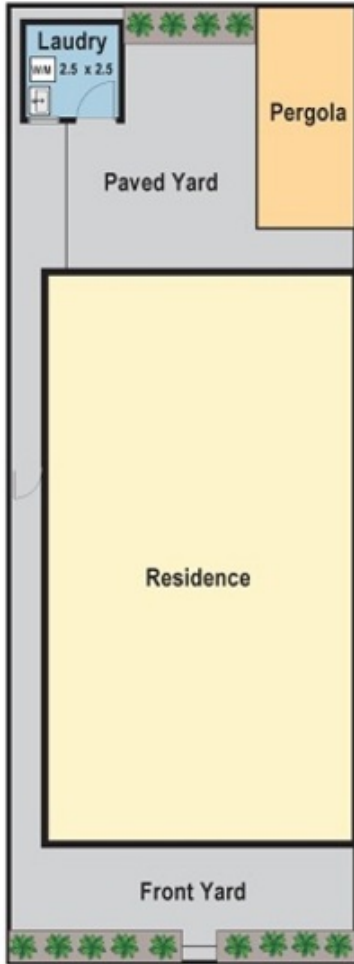

Site Plan

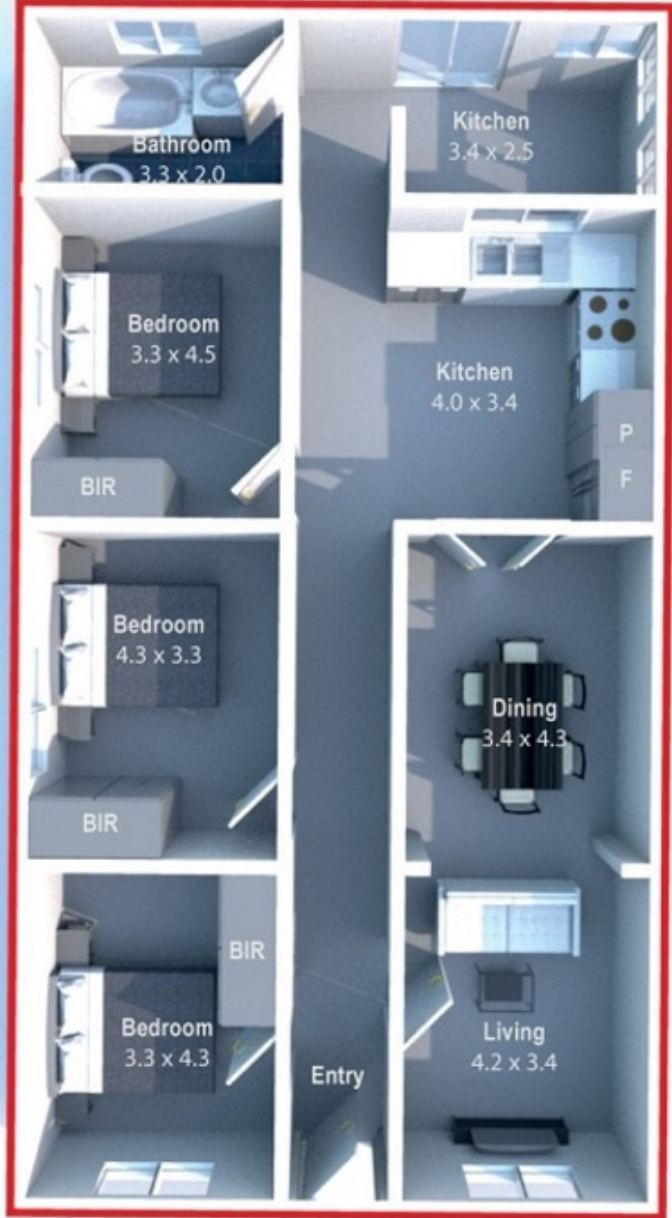

Ground Floor