





1/36 GEORGE STREET EASTLAKES NSW

3  3  2 

On offer, this original north facing double brick townhouse situated in one of Eastlakes best streets. This townhouse is the front street facing home. and features:

- *3 Huge bedrooms
- *Master bedroom en-suite and large balcony
- *Front garden area (not a typical courtyard)
- *Expansive open plan lounge and dining
- *243sqm (Internal and External Total)
- *Original granite kitchen
- *Double Lock-Up Garage
- *Modern main bathroom with spa bath
- *Low levies
- *3 x w/c plus internal laundry.

Price : \$ 1,035,000

View : <https://www.rre.com.au/545607>



RRE Properties Rosebery
029667 2868

Unrivaled with the benefit of being north facing and the front townhouse in an exclusive small complex of only 3.



First Floor

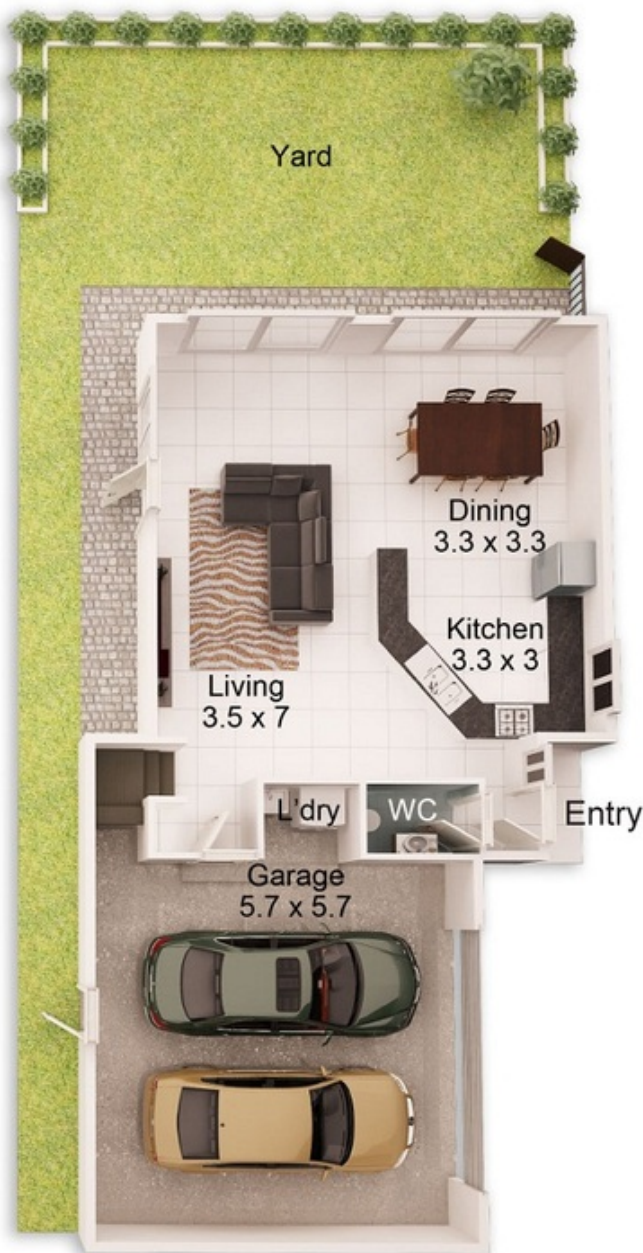

Ground Floor



1 / 36 GEORGE STREET

EASTLAKES

DISCLAIMER: ARTUM PLANS SHOWN ARE FOR PRESENTATION PURPOSES & ARE NOT PART OF ANY LEGAL DOCUMENT. ALL MEASUREMENTS & FIGURES ARE APPROXIMATE. FLOOR PLANS, PHOTOGRAPHY & GRAPHIC DESIGN BY ARTUMPROPERTYMARKETING.COM