





2/48-50 Beauchamp Road Hillsdale NSW

3  2  2 

Located in the newly completed boutique development of just nine premier residences, this beautiful corner position Casa Colina townhouse sets the benchmark in Hillsdale for contemporary living. State-of-the-art inclusions are matched with luxurious finishes and the latest design elements to provide you with the ultimate low maintenance lifestyle. Features include:

- *Tri Level Design
- * 3 bedrooms + study/infants Room
- * Master bedroom with walk-in robe, en-suite and balcony
- * Spacious lounge and dining areas
- * 2 Vogue bathrooms with 3 x w/c and internal laundry
- * Large rear courtyard
- * Gourmet stone gas kitchen with quality appliances including dishwasher
- * Ducted Daikin air conditioning

View : <https://www.rre.com.au/5242379>



Andrea Kyriakou
02 9667 2868

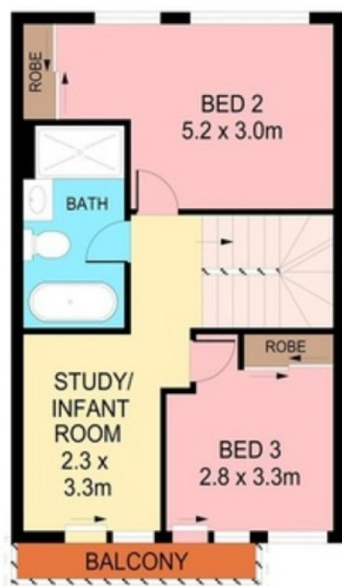

FIRST FLOOR

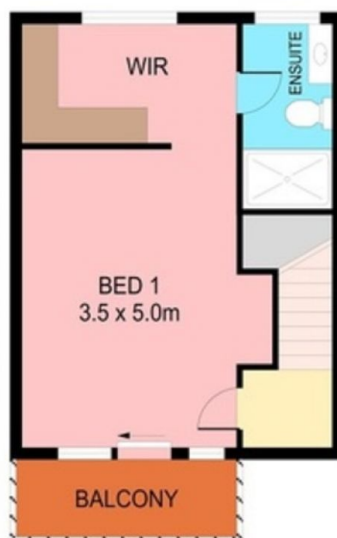

SECOND FLOOR

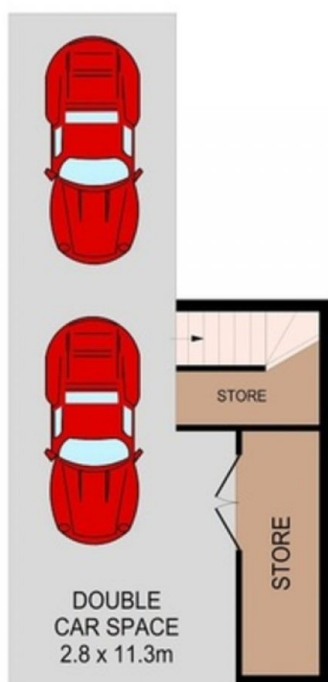

LOWER GROUND FLOOR

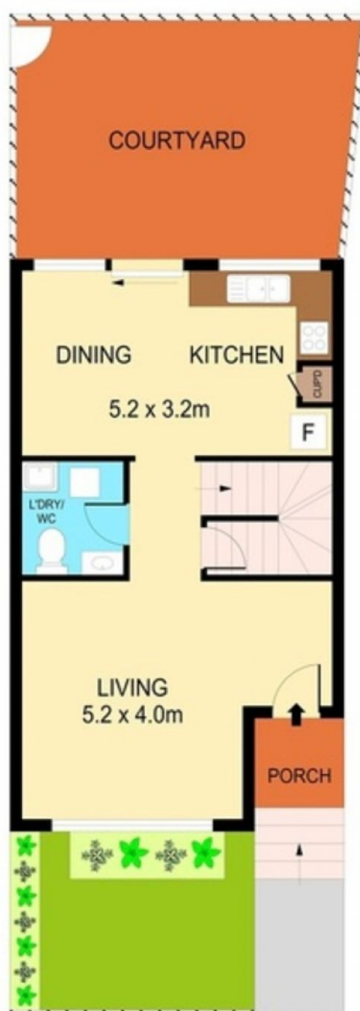

GROUND FLOOR



PLANS SHOWN ONLY INDICATIVE OF LAYOUT. DIMENSIONS ARE APPROXIMATE.
Ref. No: 67821

2/48-50 BEAUCHAMP ROAD

HILLSDALE