



**2/48-50 Beauchamp Road HILLSDALE NSW**

**3  2  2 **

Welcome to Townhouse 2 of Casa Colina, offered off the plan in a boutique development of just nine premier residences that have been designed to set the benchmark in Hillsdale and Matraville for contemporary living. State-of-the-art inclusions are matched with luxurious finishes and the latest design elements to provide you with the ultimate low maintenance lifestyle.

Expected to be completed in 12 months, townhouse 2 offers

- \*Tri Level Design
- \*3 Bedrooms + Study/Media Room
- \*Spacious lounge and dining area with rear yard
- \*2 Vogue bathrooms with 3 x w/c
- \*2 Balconies plus front and rear yards
- \*Ceaserstone gourmet kitchens with Smeg gas and Smeg appliances

**Price : \$ 1,058,000**

**View : <https://www.rre.com.au/2152295>**



**RRE Properties Rosebery  
029667 2868**



GROUND FLOOR PLAN

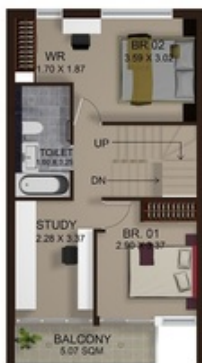

FIRST FLOOR PLAN



SECOND FLOOR PLAN



BASEMENT FLOOR PLAN

## TOWNHOUSE 02

Total Area excluding parking: **180sqm**

Parking Area: **50sqm**

Total Area on title: **230sqm**

SCALE 1:50

