





5/48-50 Beauchamp Road HILLSDALE NSW

3  2  2 

Welcome to Townhouse 5 of Casa Colina, a bespoke residence offered off the plan in a boutique development of just nine premier residences that have been designed to set the benchmark in Hillsdale and Matraville for contemporary living. State-of-the-art inclusions are matched with luxurious finishes and the latest design elements to provide you with the ultimate low maintenance lifestyle.

Townhouse 5 Offers:

- *Tri Level Design - Corner position (largest sqm in development ex parking 229sqm)
- *3 Bedrooms + Study/Media Room
- *Spacious lounge and dining area with rear yard
- *2 Vogue bathrooms with 3 x w/c
- *2 Balconies plus large wrap around yard
- *Ceaserstone gourmet kitchens with Smeg gas and Smeg appliances

Price : \$ 1,118,000

View : <https://www.rre.com.au/2141012>



**RRE Properties Rosebery
029667 2868**



GROUND FLOOR PLAN

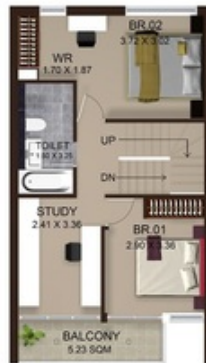

FIRST FLOOR PLAN



SECOND FLOOR PLAN



BASEMENT FLOOR PLAN

TOWNHOUSE 05

Total Area excluding parking: 229sqm

Parking Area: 38sqm

Total Area on title: 268sqm

SCALE 1:50

